



Weather
High 58
Low 31
 Precipitation
0.00

Reports No.
54

Project No.
1145

Report Date:
11/28/16

Day of Week:
Monday



Daily Progress Report

Copyright 2005, Sevenson Environmental Services, Inc.
 All Rights Reserved. ©

Weather Conditions:

Clear



1 Sennebogen dredging in the Access Channel with new Anvil bucket with teeth attachments



2 Loading a scow with sandy material



3 Loading a truck to be hauled to Cape Mining Landfill



4 Full scow being transported to 81st street for unloading



5 Moving amended dredge material on the pad



6 Dredging operations in the Access Channel

Work Performed by Severson

- Continued communication with residents regarding residential slip dredging
- Continued survey of resident boat slips
- Continued blending dredge material with Portland Cement
- Continued staging blended dredge material in anticipation of disposal
- Continued noise level monitoring activities
- Continued dust monitoring activities
- Continued dredging in the Access Channel

- Sennebogen removed 398 CYS from the Access Channel
- Disposed of 730 tons of dredge material from the Access Channel to Cape Mining Landfill

- The Stone Harbor Blvd bridge is now open with a 15 ton weight limit. This still impacts disposal operations but should not effect dredging operations any longer.

Weekly Summary

Date		Dredge QTY (CY)	Disposal QTY (Tns)
11/28/16	Mon	398	730
11/29/16	Tue	--	--
11/30/16	Wed	--	--
12/01/16	Thu	--	--
12/02/16	Fri	--	--
12/03/16	Sat	--	--
12/04/16	Sun	--	--
Weekly Totals		398 CY	730 Tns

Safety Remarks

- No accidents or incidents observed or reported.
- Conducted daily safety meeting: Equipment Inspection

Remarks/Verbal Directives

- None

Work Performed by Subcontractors

Planned Activities

- Continue survey of residential slips for residential slip dredging
- Continue load out of dredge material
- Continue dredging in the Access Channel

Equipment/Materials Delivered to Site

- FOR A LIST OF EQUIPMENT RECEIVED TODAY PLEASE SEE PAGE 3

Other Information

Production Tables

Disposal	Kinsley	Cape Mining	Beach	Other	Other	Total	Unit
Today	0	730				730	Tons
Previous	4,667	24,663				29,330	Tons
Total	4,667	25,393				30,060	Tons

Dredging	Available Pay (CY)	Quantity Data Source	Dredged Today (CY)	Dredged To Date (CY)	% Complete
South Basin	4,862	2016 AD Survey	0	3,385	100%
Snug Harbor	9,445	2016 AD Survey	0	6,153	100%
Shelter Haven Entrance	1,834	2016 AD Survey	0	1,303	100%
Stone Harbor	4,878	2016 AD Survey	0	3662	100%
Pleasure Bay	10,184	Contract Bid Sheet	0	198	2%
Carnival Bay	15,874	Contract Bid Sheet	0	0	0%
Sanctuary Bay	16,391	Contract Bid Sheet	0	0	0%
Paradise Bay	10,517	Contract Bid Sheet	0	0	0%
Access Channel	20,875	Contract Bid Sheet	398	2863	14%
Stone Harbor Hole	0	Contract Bid Sheet	0	0	0%
Tuxedo Cove	2,552	2016 BD Survey	0	2241	100%
Residential Dredging	1,267	2016 BD Survey	0	1417	112%
*** Fire Boat Slip	188	Fire Boat AD Survey	0	188	100%
TOTALS	98,867		398	21,410	23%

* Volumes include Required and Allowable Pay Overdepth **100% Complete when approved by Owner

*** Change Order

Sevenson Equipment List

SES Equipment #	Make/Model	Description	Date Onsite	Hrs	Qty
Heavy Equipment					
773-E	Cat 336E Ex	Cat Excavator	11/2/2016		1
1848-E	Komatsu PC 350 Ex	PC 350 Excavator	9/20/2016		1
	Komatsu PC 400 LF	PC 400 LF Excavator	11/10/2016		1
1243-E	Sennebogen 860	Material Handler	9/13/2016		1
1246-16	Sennebogen 860	Material Handler	9/16/2016		1
1057-E	Cat 950 Loader	Cat 950 Front End Loader	9/14/2016		1
1085-E	Cat 966 Loader	Cat 966 Front End Loader	9/21/2016		1
655-32	Komatsu 450 Loader	Komatsu 450-3MC Loader	11/2/2016		1
840-E	JCB Lodall	Telescoping Forklift	9/13/2016		1
1050-E	JCB 190 Skid Steer	Rubber Tire Skid Steer	9/15/2016		1
Buckets					
1246-1B	Anvil Bucket	4.0 CY Clamshell Bucket	9/13/2016		1
10664-19	Anvil Bucket	3.5 CY Clamshell Bucket	10/31/2016		1
	Anvil Bucket	3.5 CY Clamshell w/ Teeth	11/18/2016		
9010-18	Cablearm Bucket	5CY Cablearm Clamshell Bucket	10/6/2016		1
Compressor / Generator					
835-E	IR 185 Compressor	Air Compressor 185	9/15/2016		1
1404-E	XQ60 Generator	Generator XQ60	9/15/2016		1
Light Plants					
1206-E	Genie Light Tower	Genie Light Tower / Generator	9/21/2016		1
670-E	Terex RL 400 Light	Light Plant	9/20/2016		1
999-E	Terex RL 400 Light	Light Plant	9/21/2016		1
	Terex RL 400 Light	Light Plant	10/10/2016		1
	Terex RL 400 Light	Light Plant	10/10/2016		1
	Terex RL 400 Light	Light Plant	10/10/2016		1
	Terex RL 400 Light	Light Plant	10/20/2016		1
	Terex RL 400 Light	Light Plant	10/20/2016		1
	Terex RL 400 Light	Light Plant	10/20/2016		1
Seabox					
BB24420	Seabox	Seabox	9/13/2016		1
234056	Seabox	Seabox	9/15/2016		1
Vehicles					
13-66	Ford F250 Pickup	Pickup	10/6/2016		1
301-63	Street Sweeper	International Sweeper Truck	11/1/2016		1
Water Treatment System					
1458-E	Bag Filter Housing	Bag Filter Housing	9/20/2016		1
1716-E	Bag Filter Housing	Bag Filter Housing	9/20/2016		1
1673-E	Bag Filter Housing	Bag Filter Housing	9/20/2016		1
1718-E	Bag Filter Housing	Bag Filter Housing	9/20/2016		1
1674-E	Bag Filter Housing	Bag Filter Housing	9/20/2016		1
1762-E	Bag Filter Housing	Bag Filter Housing	9/20/2016		1
Boats					
	Hydraulic Push Boat	Hydraulic Push Boat	10/12/2016		1
	Yamaha Twin Outboard	Push Boat	10/24/2016		1
8721-E	Bumblebee Boat	Push Boat	9/14/2016		1
1706-E	Tugboat	Shirley Tugboat	9/15/2016		1
1720-83	Tugboat	7 Bells Tugboat	10/6/2016		1
1657-E	Dredge Tender	DSC Dredge Tender	9/23/2016		1
1318-E	Triumph 21' Boat	Boat	9/20/2016		1
Rake Ends / Spuds					
RAKE ENDS	BARGE RAKE ENDS	BARGE RAKE ENDS	9/23/2016		4
1284-46	Poseidon 50' Spud SP 2	Poseidon Spud	10/6/2016		1

Sevenson Equipment List

Rental Equipment	Make/Model	Description	Date Onsite	Hrs	Qty
Barges					
PF7-127RCT	Poseidon Barge 40'	40'x10'x7' Barge	9/14/2016		1
PF7-179QCT	Poseidon Barge 40'	40'x10'x7' Barge	9/14/2016		1
247B008	Poseidon Barge 40'	40'x10'x7' Barge	9/14/2016		1
PF7-128RCT	Poseidon Barge 40'	40'x10'x7' Barge	9/14/2016		1
990EC	Shakerton Barge 40'	40'x10'x5' Barge	9/14/2016		1
019917	Shakerton Barge 40'	40'x10'x5' Barge	9/14/2016		1
J-111-E	Shakerton Barge 40'	40'x10'x5' Barge	9/14/2016		1
990EJ	Shakerton Barge 40'	40'x10'x5' Barge	9/14/2016		1
019919	Shakerton Barge 40'	40'x10'x5' Barge	9/14/2016		1
990ER	Shakerton Barge 40'	40'x10'x5' Barge	9/14/2016		1
PF2713QC	Poseidon Barge 20'	20'x10'x5' Barge	9/15/2016		1
PF27132QCT	Poseidon Barge 20'	20'x10'x5' Barge	9/15/2016		1
227B006	Poseidon Barge 20'	20'x10'x5' Barge	9/15/2016		1
227B033	Poseidon Barge 20'	20'x10'x5' Barge	9/15/2016		1
247B034	Poseidon Barge 40'	40'x10'x7' Barge	9/15/2016		1
247C134	Poseidon Barge 40'	40'x10'x7' Barge	9/15/2016		1
P114Q	Poseidon Barge 40'	40'x10'x5' Barge	9/15/2016		1
990Ea	Shakerton Barge 40'	40'x10'x5' Barge	9/15/2016		1
9928	Shakerton Barge 40'	40'x10'x5' Barge	9/15/2016		1
996EB	Shakerton Barge 40'	40'x10'x5' Barge	9/15/2016		1
996EG	Shakerton Barge 40'	40'x10'x5' Barge	9/15/2016		1
9649	Shakerton Barge 20'	40'x10'x5' Barge	9/15/2016		1
9947	Shakerton Barge 20'	40'x10'x5' Barge	9/15/2016		1
9648	Shakerton Barge 20'	40'x10'x5' Barge	9/15/2016		1
9650	Shakerton Barge 20'	40'x10'x5' Barge	9/15/2016		1
	Shakerton Barge	40' x 10' x 5' Barge	10/6/2016		9
Scows					
1906-85	Scow Open Top	Scow Open Top	10/6/2016		1
1908-85	Scow Open Top	Scow Open Top	10/6/2016		1
1962-85	Scow Open Top	Scow Open Top	10/6/2016		1
1963-85	Scow Open Top	Scow Open Top	10/6/2016		1
1964-85	Scow Open Top	Scow Open Top	10/6/2016		1
1968-85	Scow Open Top	Scow Open Top	10/6/2016		1
1966-85	Scow Open Top	Scow Open Top	10/6/2016		1
1910-85	Scow Open Top	Scow Open Top	10/28/2016		1
1996-85	Scow Open Top	Scow Open Top	10/28/2016		1

Rental Equipment List

Frac Tank	Adler	Adler Open Top Weir Tank	9/16/2016		2
Frac Tank	Adler	21K Gal Frac Tank	9/16/2016		1
Roll Off	Adler	Adler Roll Off Geotube Box	9/20/2016		3
1288-1B	Anvil	3.5CY Clamshell Bucket	9/14/2016		1
	Anvil	3.5CY Clamshell Bucket - DEMO	10/14/2016		1
Roll Off Container	H4	Roll Off Container	9/20/2016		1
Roll Off Container	H4	Roll Off Container	9/20/2016		1
Break Trailer	Modspace	Break Trailer	9/12/2016		1
Office Trailer	Modspace	Office Trailer	9/23/2016		1
Barge Floats	Northstar Marine	Flexi Floats	11/14/2016		6
Light Plants	Sunbelt Rentals	Light Plants	11/1/2016		4
Noise Meter	Pine Environmental	Pine Environmental Noise Meter	9/26/2016		1
500 gal fuel tank	Taylor Oil	Gas Tank	9/20/2016		1
500 gal fuel tank	Taylor Oil	Off Road Diesel Tank	9/20/2016		1

Labor

SES Personnel		
Shift: Day		Hrs
0	General Superintendent	0.0
1	Project Manager	12.0
1	Project Superintendent	12.0
1	Timekeeper	8.0
0	QA/QC Manager	0.0
1	Surveyor	12.0
1	Mechanic	10.0
0	Health and Safety	0.0
0	SES Foreman	0.0
1	Labor Foreman 172/472	11.0
5	Laborer 172/472	50.0
4	Operator 825	40.0
2	Licensed Boat Op 25	24.0
1	Mate 25	12.0
3	Deckhand 25	36.0
1	Dredge Op 25	12.0
22	Totals	239.0

[illegible]

Day Shift Employees	22
---------------------	----

Night Shift Employees	0
-----------------------	---

Daily Total Employees	22
-----------------------	----

Day Shift Hours	239.0
-----------------	-------

Night Shift Hours	0.0
-------------------	-----

Today's Man Hours	239.0
-------------------	-------

**Total Man Hours
to Date** **10,555.0**

[illegible][illegible]

Total Man Hours Since Last Time Incident	10,555.0
--	----------

Lost Time Incidents To-Date - 0

Last Lost Time Incident -
N/a

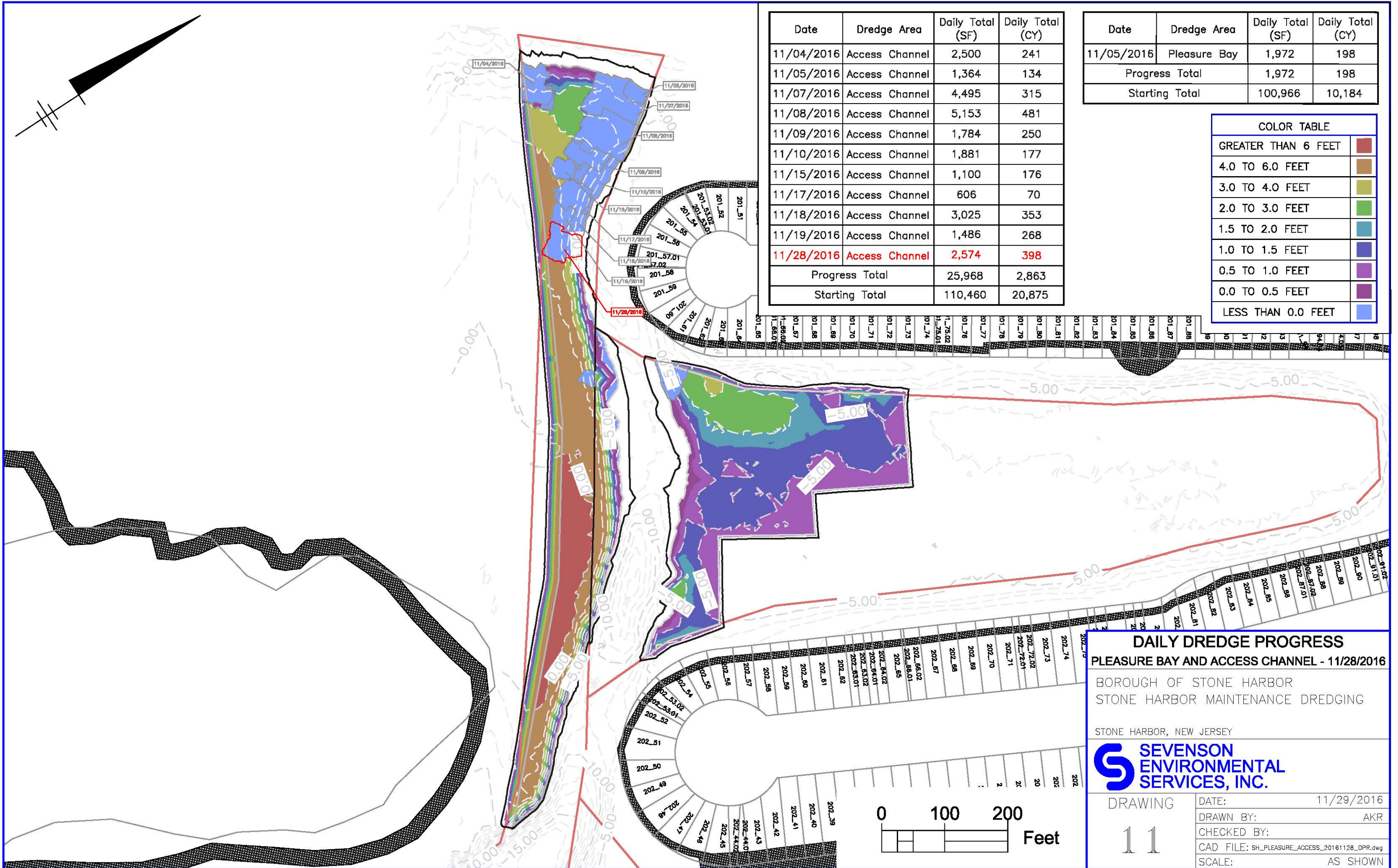

Date	Dredge Area	Daily Total (SF)	Daily Total (CY)
11/04/2016	Access Channel	2,500	241
11/05/2016	Access Channel	1,364	134
11/07/2016	Access Channel	4,495	315
11/08/2016	Access Channel	5,153	481
11/09/2016	Access Channel	1,784	250
11/10/2016	Access Channel	1,881	177
11/15/2016	Access Channel	1,100	176
11/17/2016	Access Channel	606	70
11/18/2016	Access Channel	3,025	353
11/19/2016	Access Channel	1,486	268
11/28/2016	Access Channel	2,574	398
Progress Total		25,968	2,863
Starting Total		110,460	20,875

Date	Dredge Area	Daily Total (SF)	Daily Total (CY)
11/05/2016	Pleasure Bay	1,972	198
Progress Total		1,972	198
Starting Total		100,966	10,184

COLOR TABLE	
GREATER THAN 6 FEET	
4.0 TO 6.0 FEET	
3.0 TO 4.0 FEET	
2.0 TO 3.0 FEET	
1.5 TO 2.0 FEET	
1.0 TO 1.5 FEET	
0.5 TO 1.0 FEET	
0.0 TO 0.5 FEET	
LESS THAN 0.0 FEET	

DAILY DREDGE PROGRESS

PLEASURE BAY AND ACCESS CHANNEL - 11/28/2016

BOROUGH OF STONE HARBOR

STONE HARBOR MAINTENANCE DREDGING

STONE HARBOR, NEW JERSEY

SEVENSON

ENVIRONMENTAL

SERVICES, INC.

DRAWING

11

DATE:

11/29/2016

DRAWN BY:

AKR

CHECKED BY:

CAD FILE:

SH_PLEASURE_ACCESS_20161128_DPR.dwg

SCALE:

AS SHOWN